

Table Tennis Club Venue Layout & Use Guidance under Covid-19



Example: Leisure Centre
Session: Club open practice

General Principles

In line with our [5 stage process](#) clubs will need to consider the following measures to ensure club rooms are as safe to play in as possible by: reducing table numbers, the length of sessions, the number of players allowed into the venue at any one time and increasing playing fees to cover costs. The guidelines below are recommendations and may need to be tailored to fit individual facility constraints. Please also refer to the [Hygiene and Facility Guidance document](#), which has additional detail in some areas.

Venue Set Up

- Court size 9m x 4.5m
- Designated walkways to courts → → ensuring 1m+/2m distancing
- Venue to be kept well ventilated, with any ventilation system kept on or windows/doors remaining open wherever possible *
- Fixing doors open that can be safely left open where feasible
- Bags to be taken into courts
- Table at entrance for hand gel
- Organiser to wear gloves for setting up and wiping down the tables and chairs after the session
- Organiser to keep a register of players for track & trace

Social Distancing & Hygiene Measures

- Government social distancing & hygiene measures to be followed at all times
- Players not to attend if they or any member of their family has shown symptoms of the virus
- No cash payments to be taken
- Players to agree in advance to follow guidance provided
- Players to stay 1m+/2m apart as much as possible
- Players can play in bubbles of six, with social distancing measures adhered to, [see Hygiene and Facility Guidance *](#)
- No doubles play, unless from the same household
- No handshaking, breathing on the ball or wiping hands on the table
- Towels and water bottles to always be kept in a player's bag
- 2 players per court and up to 50% additional players plus 1 organiser/coach per session
- For league play 6 players are allowed per court if space and social distancing can be adhered to, [see Local League Guidance, min m² required *](#)
- Parents to stay outside the playing hall, unless by prior agreement
- Keep to the side of the hall when accessing the court
- Bring own personal bat and TT balls
- Ensure TT balls are cleaned regularly, surrounds not to be handled by players
- No use of changing rooms or showers, except for toilets.
- Players to use own hand gel each session

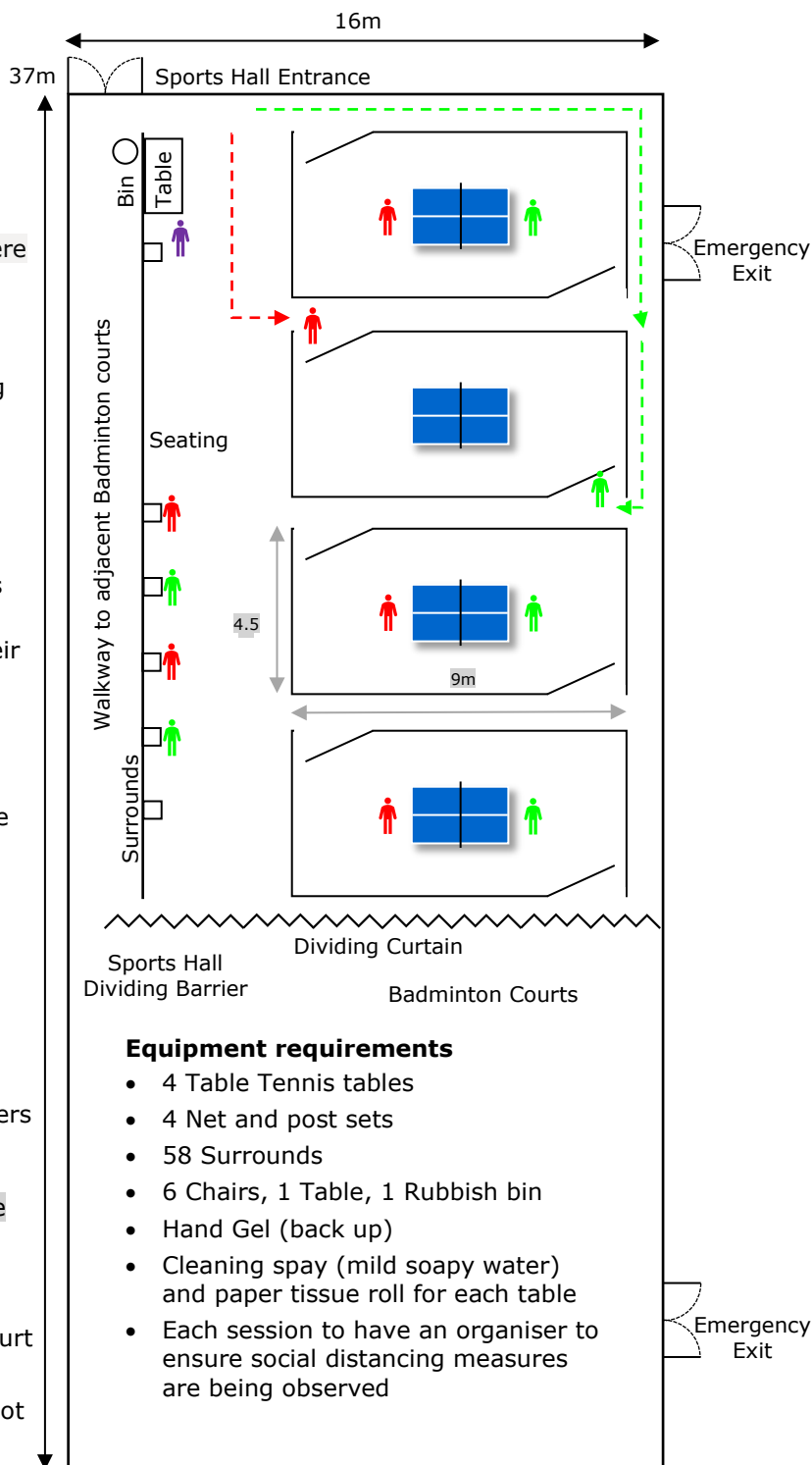

Equipment requirements

- 4 Table Tennis tables
- 4 Net and post sets
- 58 Surrounds
- 6 Chairs, 1 Table, 1 Rubbish bin
- Hand Gel (back up)
- Cleaning spay (mild soapy water) and paper tissue roll for each table
- Each session to have an organiser to ensure social distancing measures are being observed